

## **Getting Started**

Controller

Visit [skydio.com/getstarted](https://skydio.com/getstarted) for  
the full user manual.

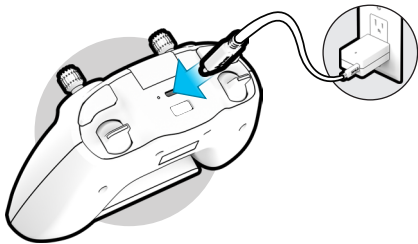

### Charge Controller

Charge Controller using USB-C vehicle charging cable.

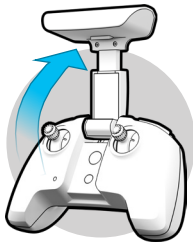

### Unfold Controller to Power On

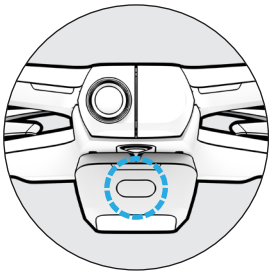

### Power on Skydio 2

Hold the Battery Power Button for 3 seconds to power on Skydio 2.

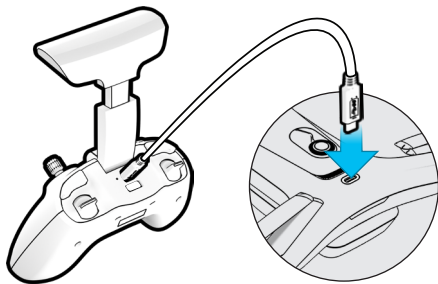

### Plug Controller into Skydio 2

Plug Controller into Skydio 2 using the included USB-C cable.

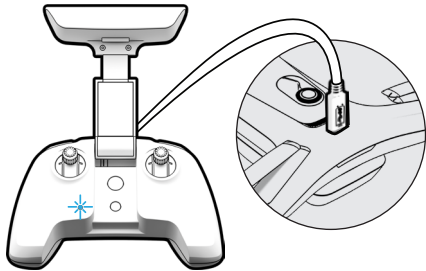

### Wait Until Light Turns Blue

Wait until light turns solid. Controller is paired with Skydio 2 when the flashing blue light turns solid.

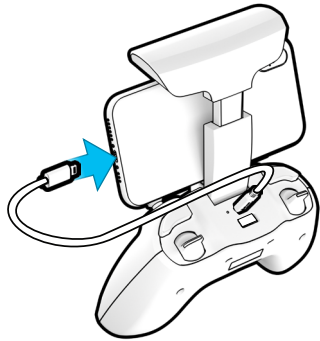

### Connect Phone

Place phone into the antenna arm. Connect phone to controller using the appropriate cable (Android or iOS).

For legal and patent information  
visit [www.skydio.com/legal](http://www.skydio.com/legal)

Use of the Made for Apple badge means that an accessory has been designed to connect specifically to the Apple products identified in the badge and has been certified by the developer to meet Apple performance standards. Apple is not responsible for the operation of this device or its compliance with safety and regulatory standards. Please note that the use of this accessory with an Apple product may affect wireless performance.

Apple, iPad, iPad Air, iPad Pro, iPhone, and iPod touch are trademarks of Apple Inc., registered in the U.S. and other countries.